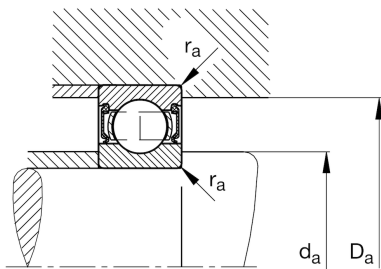
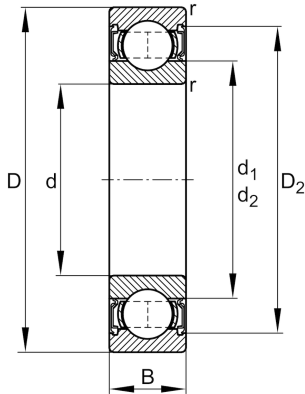

**FAG****S6202-2RSR-HLC**

Deep groove ball bearing

Materiálové číslo Schaeffler:
0554286810000Deep groove ball bearing S62...-2RSR,
corrosion-resistant materials, single row,
seals, steel sheet metal cage

Technické informace

**Main Dimensions & Performance Data**

d	15 mm	Bore diameter
D	35 mm	Outside diameter
B	11 mm	Width
C_r	6.490 N	Basic dynamic load rating, radial
C_{0r}	2.980 N	Basic static load rating, radial
C_{ur}	189 N	Fatigue load limit, radial
n_G	12.300 1/min	Limiting speed
	45 g	{Hmotnost}

Mounting dimensions

$d_{a \min}$	19,2 mm	Minimum diameter shaft shoulder
$D_{a \max}$	30,8 mm	Maximum diameter of housing shoulder
$r_{a \max}$	0,6 mm	Maximum fillet radius

Dimensions

r_{\min}	0,6 mm	Minimum chamfer dimension
D_2	31,4 mm	Caliber diameter outer ring
d_1	21,7 mm	Shoulder diameter inner ring

Temperature range

T_{\min}	-30 °C	Operating temperature min.
T_{\max}	100 °C	Operating temperature max.

Calculation factors

f_0	10,5	Calculation factor
-------	------	--------------------