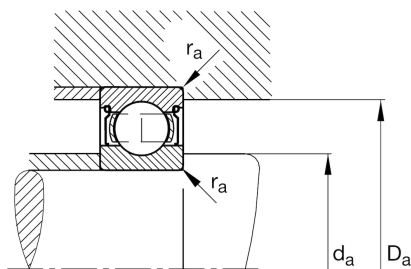
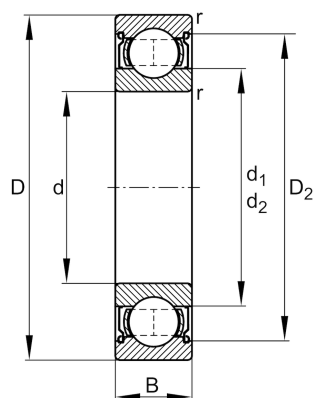

**FAG****6313-2Z-C4**

Deep groove ball bearing

Materiálové číslo Schaeffler:
0167239610040Deep groove ball bearing 63...-2Z, single
row, shields, steel sheet metal cage

Technické informace

**Main Dimensions & Performance Data**

d	65 mm	Bore diameter
D	140 mm	Outside diameter
B	33 mm	Width
C_r	100.000 N	Basic dynamic load rating, radial
C_{0r}	60.000 N	Basic static load rating, radial
C_{ur}	4.050 N	Fatigue load limit, radial
n_G	6.200 1/min	Limiting speed
n_{gr}	6.400 1/min	Reference speed
	2,16 kg	Hmotnost

Mounting dimensions

$d_{a \min}$	77 mm	Minimum diameter shaft shoulder
$D_{a \max}$	128 mm	Maximum diameter of housing shoulder
$r_{a \max}$	2,1 mm	Maximum fillet radius

Dimensions

r_{\min}	2,1 mm	Minimum chamfer dimension
D_2	122,2 mm	Caliber diameter outer ring
d_1	88,3 mm	Shoulder diameter inner ring

Temperature range

T_{\min}	-20 °C	Operating temperature min.
T_{\max}	120 °C	Operating temperature max.

Calculation factors

f_0	13,2	Calculation factor
-------	------	--------------------