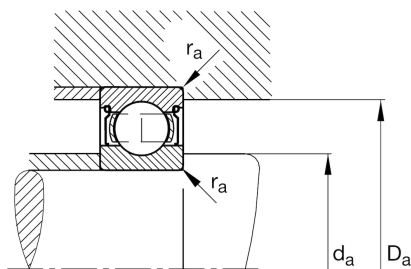
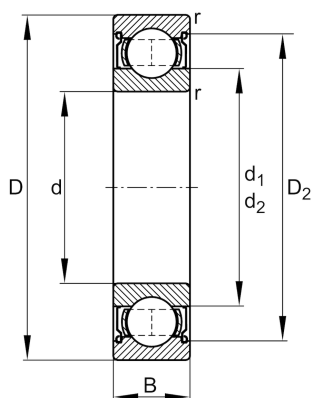

**FAG****6009-Z**

Deep groove ball bearing

Materiálové číslo Schaeffler:
0190026610000Deep groove ball bearing 60...-Z, single
row, shield, steel sheet metal cage

Technické informace

**Main Dimensions & Performance Data**

d	45 mm	Bore diameter
D	75 mm	Outside diameter
B	16 mm	Width
C_r	21.200 N	Basic dynamic load rating, radial
C_{0r}	14.400 N	Basic static load rating, radial
C_{ur}	750 N	Fatigue load limit, radial
n_G	13.100 1/min	Limiting speed
n_{gr}	9.700 1/min	Reference speed
	0,235 kg	Hmotnost

Mounting dimensions

$d_{a \min}$	49,6 mm	Minimum diameter shaft shoulder
$D_{a \max}$	70,4 mm	Maximum diameter of housing shoulder
$r_{a \max}$	1 mm	Maximum fillet radius

Dimensions

r_{\min}	1 mm	Minimum chamfer dimension
D_2	68 mm	Caliber diameter outer ring
d_1	54,2 mm	Shoulder diameter inner ring

Temperature range

T_{\min}	-30 °C	Operating temperature min.
T_{\max}	120 °C	Operating temperature max.

Calculation factors

f_0	15,3	Calculation factor
-------	------	--------------------