

**FAG****B7003-E-T-P4S-UL**

## Spindle bearing

Spindle bearing B70..-E, adjusted, in pairs or sets, contact angle  $\alpha = 25^\circ$ , restricted tolerances

Materiálové číslo Schaeffler: 0191500080000

## Technické informace

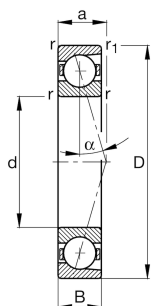

## Vaše aktuální varianta produktu

Preload	L	Preload light
Contact angle	E	Contact angle 25°
Tolerance class	P4S	Tolerance class P4S, FAG standard better than P4 to DIN 620
Type of Seal	Without	Not sealed
Cage	T	Laminated fabric cage
Arrangement bearing set	U	Single bearing

## Main Dimensions &amp; Performance Data

d	17 mm	Bore diameter
D	35 mm	Outside diameter
B	10 mm	Width
$C_r$	8.200 N	Basic dynamic load rating, radial
$C_{0r}$	3.350 N	Basic static load rating, radial
$C_{ur}$	355 N	Fatigue load limit, radial
$n_G$ Grease	43.000 1/min	Limiting speed for grease lubrication
$n_G$ Oil	63.000 1/min	Limiting speed for oil lubrication
$\approx m$	0,04 kg	Hmotnost

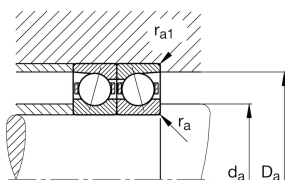
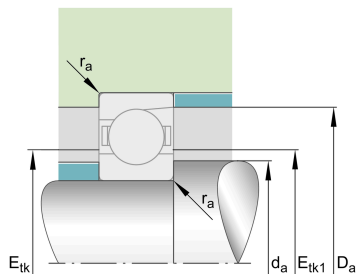



### Mounting dimensions

$d_a$	21 mm	Diameter shaft shoulder
$d_a$	h12	Diameter shaft shoulder clearance
$D_a$	32 mm	Shoulder diameter outer ring
$D_a$	H12	
$r_{a \max}$	0,3 mm	Maximum recess radius
$r_{a1 \max}$	0,1 mm	Maximum recess radius
$E_{tk \min}$	23,3 mm	Minimum diameter injection pitch
$E_{tk \max}$	24,5 mm	Maximum diameter injection pitch
$E_{tk1 \min}$	23,3 mm	Minimum diameter injection pitch
$E_{tk1 \max}$	24,5 mm	Maximum diameter injection pitch
$a$	11,1 mm	Distance between the apexes of the pressure cones

### Dimensions

$r_{\min}$	0,3 mm	Minimum chamfer dimension
$r_{1 \min}$	0,3 mm	Minimum chamfer dimension
$\alpha$	25 °	Contact angle

### Temperature range





$T_{\min}$	-30 °C	Operating temperature min.
$T_{\max}$	100 °C	Operating temperature max.

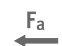

### Additional information

$F_{VL}$	54 N	Preload force light
$F_{VM}$	220 N	Preload force medium
$F_{VH}$	483 N	Preload force heavy
$K_{aEL}$	156 N	Lift-off force light
$K_{aEM}$	663 N	Lift-off force medium
$K_{aEH}$	1.504 N	Lift-off force heavy
$c_{aL}$	48 N/ $\mu$ m	Axial rigidity light
$c_{aM}$	81 N/ $\mu$ m	Axial rigidity medium
$c_{aH}$	112 N/ $\mu$ m	Axial rigidity heavy

### Vlastnosti

-  Radiální zatížení
-  Axiální zatížení v jednom směru
-  Mazání (plastickým mazivem)
-  Mazání olejem
-  Neutěsněné