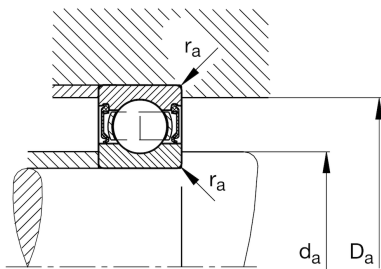
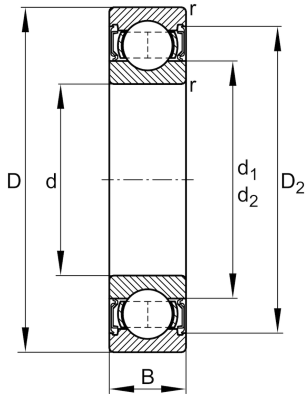

**FAG****S625-2RSR-HLC**

Deep groove ball bearing

Materiálové číslo Schaeffler:  
0551761510000Deep groove ball bearing S62...-2RSR,  
corrosion-resistant materials, single row,  
seals, steel sheet metal cage

## Technické informace

**Main Dimensions & Performance Data**

d	5 mm	Bore diameter
D	16 mm	Outside diameter
B	5 mm	Width
$C_r$	1.470 N	Basic dynamic load rating, radial
$C_{0r}$	536 N	Basic static load rating, radial
$C_{ur}$	33 N	Fatigue load limit, radial
$n_G$	31.500 1/min	Limiting speed
	5,1 g	{Hmotnost}

**Mounting dimensions**

$d_{a \min}$	7,4 mm	Minimum diameter shaft shoulder
$D_{a \max}$	13,6 mm	Maximum diameter of housing shoulder
$r_{a \max}$	0,3 mm	Maximum fillet radius

**Dimensions**

$r_{\min}$	0,3 mm	Minimum chamfer dimension
$D_2$	13,4 mm	Caliber diameter outer ring
$d_2$	7,5 mm	Caliber diameter inner ring

**Temperature range**

$T_{\min}$	-30 °C	Operating temperature min.
$T_{\max}$	100 °C	Operating temperature max.

**Calculation factors**

$f_0$	9,9	Calculation factor
-------	-----	--------------------